



SSB3020D SERIES

Low Profile Power Inductors



RoHS Compliant

PART NUMBERING SYSTEM

SSB	3020D	—	3 R 3 N	—	LF
TYPE	DIMENSIONS		INDUCTANCE		LEAD FREE

SHAPES AND DIMENSIONS

UNIT : mm

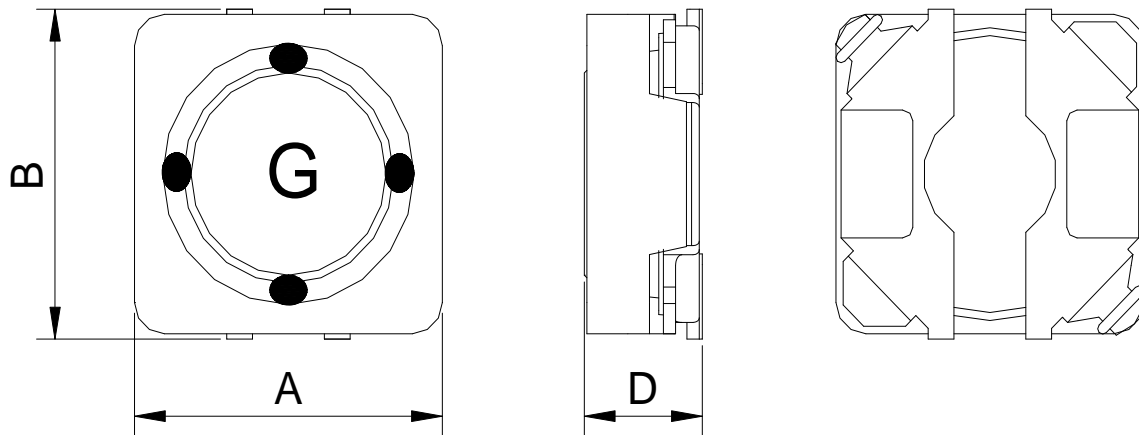

A=3.1 Max. B=3.1 Max. D=2.0 Max.

RECOMMENDED PATTERNS

UNIT : mm

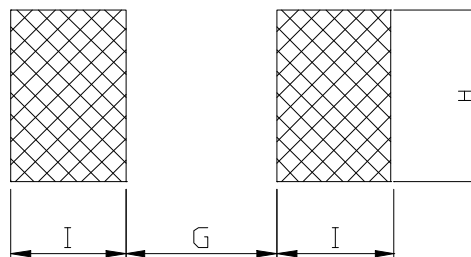

G=0.6 H=3.3 I=1.3



SSB3020D SERIES

Low Profile Shielded Power Inductors



RoHS Compliant

ELECTRICAL CHARACTERISTICS :

PART NUMBER	INDUCTANCE (μ H)	DCR (Ω) Max.(Typ.)	Isat (A) (Max.)	Irms (A) (Max.)	Stamp
SSB3020D-1R0N-LF	1.0 \pm 30%	61.2m(51m)	3.60	1.75	A
SSB3020D-1R5N-LF	1.5 \pm 30%	86.4m(72m)	2.90	1.55	C
SSB3020D-2R2N-LF	2.2 \pm 30%	0.107(89m)	2.50	1.40	E
SSB3020D-3R3N-LF	3.3 \pm 30%	0.156(0.13)	1.90	1.20	G
SSB3020D-4R7M-LF	4.7 \pm 20%	0.204(0.17)	1.60	1.05	I
SSB3020D-6R8M-LF	6.8 \pm 20%	0.312(0.26)	1.30	0.88	K
SSB3020D-100M-LF	10 \pm 20%	0.432(0.36)	1.10	0.73	M
SSB3020D-150M-LF	15 \pm 20%	0.684(0.57)	0.90	0.57	O
SSB3020D-220M-LF	22 \pm 20%	1.068(0.89)	0.74	0.40	Q
SSB3020D-330M-LF	33 \pm 20%	1.332(1.11)	0.62	0.36	S
SSB3020D-470M-LF	47 \pm 20%	2.052(1.71)	0.50	0.25	U

- Inductance tested at 100 kHz, 0.1 Vrms, 0 Adc using an Agilent/HP 4284B LCR meter or equivalent.
- Isat : DC current at which the inductance drops 30% (typ) from its value without current.
- Irms: The actual current when temperature of coil becomes Δ 40°C . (Ta=+25°C)
 Operating temperature range -40°C to +85°C , Electrical specifications at 25°C.