



SDS1608X SERIES ~ SMD Shielded Power Inductors



RoHS Compliant

PART NUMBERING SYSTEM

SDS	1608X	—	680M	—	LF
TYPE	DIMENSIONS		INDUCTANCE		LEAD FREE

FEATURES

- Low profile (height 2.92 mm max.)
- Available lead free and RoHS complaint
- Low cost and high reliability

SHAPES AND DIMENSIONS

UNIT : mm

A = 6.60 Max. B = 4.45 Max. C = 2.92 Max.

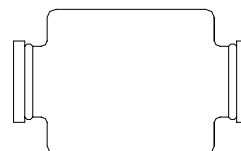
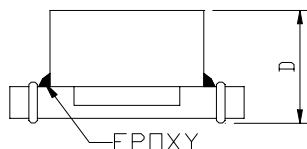
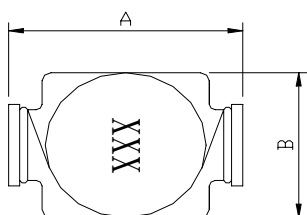

RECOMMENDED PATTERNS

UNIT : mm

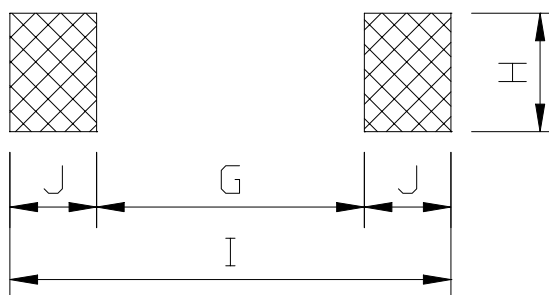

G = 4.06 H = 3.56 I = 6.86 J = 1.4



SDS1608X SERIES ~ SMD Shielded Power Inductors



RoHS Compliant

SPECIFICATION TABLE

PART NUMBER	INDUCTANCE (μ H)	DCR (Ω) (Max.)	Isat (A) (Max.)	Q (Min.)	SRF(MHz) (Ref.)
SDS1608X-1R0M-LF	1.0 \pm 20%	0.040	1.40	30 @ 200 kHz	250
SDS1608X-1R5M-LF	1.5 \pm 20%	0.045	0.93	30 @ 200 kHz	125
SDS1608X-2R2M-LF	2.2 \pm 20%	0.050	0.92	40 @ 200 kHz	120
SDS1608X-3R3M-LF	3.3 \pm 20%	0.055	0.75	40 @ 200 kHz	120
SDS1608X-4R7M-LF	4.7 \pm 20%	0.060	0.58	40 @ 200 kHz	105
SDS1608X-6R8M-LF	6.8 \pm 20%	0.065	0.58	40 @ 200 kHz	50
SDS1608X-8R2M-LF	8.2 \pm 20%	0.070	0.47	40 @ 200 kHz	42
SDS1608X-100M-LF	10 \pm 20%	0.075	0.37	40 @ 200 kHz	38
SDS1608X-150M-LF	15 \pm 20%	0.090	0.31	40 @ 100 kHz	33
SDS1608X-220M-LF	22 \pm 20%	0.11	0.30	40 @ 100 kHz	25
SDS1608X-330M-LF	33 \pm 20%	0.19	0.30	40 @ 100 kHz	20
SDS1608X-470M-LF	47 \pm 20%	0.23	0.24	40 @ 100 kHz	20
SDS1608X-680M-LF	68 \pm 20%	0.29	0.17	40 @ 100 kHz	15
SDS1608X-101M-LF	100 \pm 20%	0.48	0.13	40 @ 100 kHz	10
SDS1608X-151M-LF	150 \pm 20%	0.59	0.10	40 @ 100 kHz	9
SDS1608X-221M-LF	220 \pm 20%	0.77	0.10	40 @ 100 kHz	6
SDS1608X-331M-LF	330 \pm 20%	1.40	0.070	40 @ 100 kHz	5
SDS1608X-471M-LF	470 \pm 20%	1.80	0.060	40 @ 100 kHz	4
SDS1608X-681M-LF	680 \pm 20%	2.20	0.055	40 @ 100 kHz	3
SDS1608X-102M-LF	1000 \pm 20%	3.40	0.045	40 @ 100 kHz	2
SDS1608X-152M-LF	1500 \pm 20%	4.20	0.035	50 @ 100 kHz	2
SDS1608X-222M-LF	2200 \pm 20%	8.50	0.028	50 @ 100 kHz	2
SDS1608X-332M-LF	3300 \pm 20%	11.0	0.024	50 @ 100 kHz	1
SDS1608X-472M-LF	4700 \pm 20%	13.9	0.021	50 @ 100 kHz	1
SDS1608X-682M-LF	6800 \pm 20%	25.0	0.019	50 @ 100 kHz	1
SDS1608X-103M-LF	10000 \pm 20%	38.0	0.017	50 @ 100 kHz	0.8

- Inductance tested at 100 kHz, 0.1 Vrms.
- DC current at which the inductance drops 30% (typ) from its value without current.
- Operating temperature range -40°C to +85°C.
- Electrical specifications at 25°C .