



# SDS5020D SERIES

## Low Profile Shielded Power Inductors



RoHS Compliant

### PART NUMBERING SYSTEM

<b>SDS</b>	<b>5020D</b>	—	<b>1 R 0 N</b>	—	<b>LF</b>
TYPE	DIMENSIONS		INDUCTANCE		LEAD FREE

### SHAPES AND DIMENSIONS

UNIT : mm

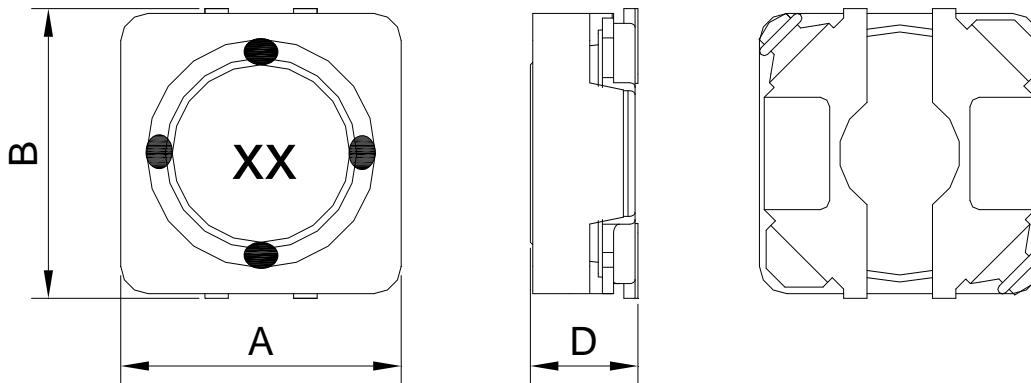

**A=5.2 Max. B=5.3 Max. D=2.0 Max.**

### RECOMMENDED PATTERNS

UNIT : mm

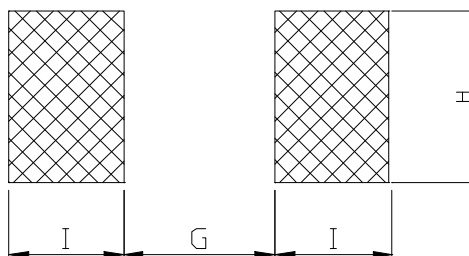

**G=1.4 H=5.4 I=2.0**



**Coilmaster Electronics Co., Ltd.**  
9F-3 No.398, Huan Bei Rd. Chung Li City, Taoyuan 320, Taiwan  
Tel : +886-3-422-8279 Fax : +886-3-422-8734

E-mail : [info@coilmaster.com.tw](mailto:info@coilmaster.com.tw)  
Web Site : [www.coilmaster.com.tw](http://www.coilmaster.com.tw)

## SDS5020D SERIES

### Low Profile Shielded Power Inductors



RoHS Compliant

#### ELECTRICAL CHARACTERISTICS :

PART NUMBER	INDUCTANCE ( $\mu$ H)	DCR ( $\Omega$ ) Max.(Typ.)	Isat (A) ( Max. )	Irms (A) ( Max. )	Stamp
SDS5020D-1R0N-LF	1.0 $\pm$ 30%	51.6m(43m)	3.80	2.60	4A
SDS5020D-2R7N-LF	2.7 $\pm$ 30%	90.0m(75m)	2.10	2.00	4F
SDS5020D-4R7M-LF	4.7 $\pm$ 20%	0.120(0.10)	1.80	1.70	4I
SDS5020D-220M-LF	22 $\pm$ 20%	0.276(0.23)	0.75	1.25	4Q
SDS5020D-470M-LF	47 $\pm$ 20%	0.480(0.40)	0.55	0.75	4U

- Inductance tested at 100 kHz, 0.1 Vrms, 0 Adc using an Agilent/HP 4284B LCR meter or equivalent.
- Isat : DC current at which the inductance drops 30% (typ) from its value without current.
- Irms: The actual current when temperature of coil becomes  $\Delta 40^{\circ}\text{C}$  . ( Ta=+25 $^{\circ}\text{C}$  )  
Operating temperature range -40 $^{\circ}\text{C}$  to +85 $^{\circ}\text{C}$  , Electrical specifications at 25 $^{\circ}\text{C}$ .