



# SBS12555SERIES ~ Shielded SMD Power Inductors



## PART NUMBERING SYSTEM

RoHS Compliant

<b>SBS</b>	<b>1 2 5 5 5</b>	<b>—</b>	<b>1 0 0 M</b>	<b>—</b>	<b>LF</b>
TYPE	DIMENSIONS		INDUCTANCE		LEAD FREE

TOP VIEW

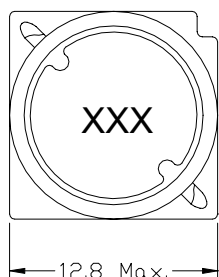

FRONT VIEW

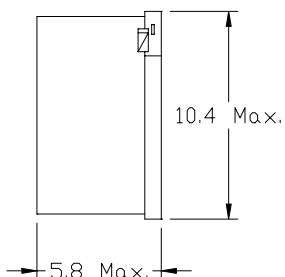

BOTTOM VIEW

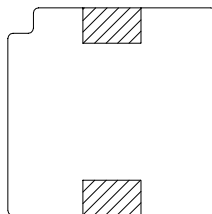

PCB PATTERN

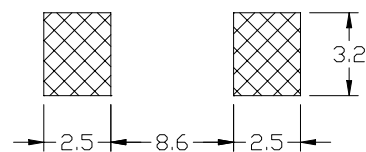

## PACKAGING SPECIFICATION

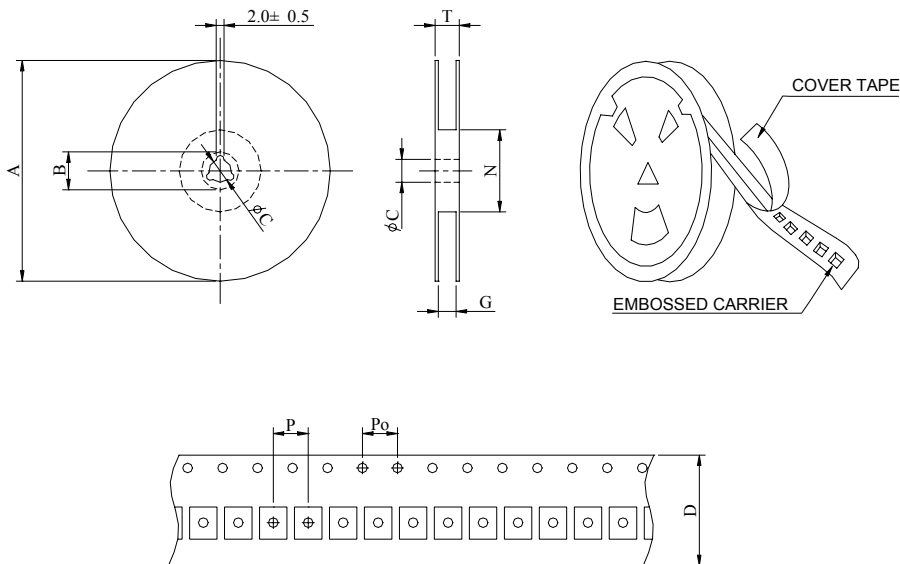

SERIES	STAYLE	Q' TY (PCS)	DIMENSIONS (m/m)								
			A	B	C	D	G	N <sup>0</sup>	P	Po	T
SBS12555	13-24	400	330	-	13.5	24	-	100	13	-	24.5



## SBS12555SERIES ~ Shielded SMD Power Inductors



### SPECIFICATION TABLE

RoHS Compliant

PART NUMBER	INDUCTANCE ( $\mu$ H)	DCR ( $\Omega$ ) (Max.)	IDC (A) (Max.)	TEST FREQ. ( f )
SBS12555-6R0N-LF	6.0 $\pm$ 30%	0.0164	3.6	1KHz
SBS12555-100M-LF	10 $\pm$ 20%	0.0215	3.4	1KHz
SBS12555-150M-LF	15 $\pm$ 20%	0.0259	2.8	1KHz
SBS12555-220M-LF	22 $\pm$ 20%	0.0338	2.3	1KHz
SBS12555-330M-LF	33 $\pm$ 20%	0.0415	1.9	1KHz
SBS12555-470M-LF	47 $\pm$ 20%	0.0618	1.6	1KHz
SBS12555-680M-LF	68 $\pm$ 20%	0.0832	1.3	1KHz
SBS12555-101M-LF	100 $\pm$ 20%	0.1170	1.1	1KHz
SBS12555-151M-LF	150 $\pm$ 20%	0.19	0.88	1KHz
SBS12555-221M-LF	220 $\pm$ 20%	0.27	0.72	1KHz
SBS12555-331M-LF	330 $\pm$ 20%	0.41	0.59	1KHz
SBS12555-471M-LF	470 $\pm$ 20%	0.52	0.49	1KHz
SBS12555-681M-LF	680 $\pm$ 20%	0.76	0.43	1KHz
SBS12555-102M-LF	1000 $\pm$ 20%	1.12	0.34	1KHz
SBS12555-152M-LF	1500 $\pm$ 20%	1.73	0.29	1KHz

- DC current at which the inductance drops 10% (typ) from its value without current.
- Operating temperature range -20 $^{\circ}$ C to +105 $^{\circ}$ C ,
- Electrical specifications at 25 $^{\circ}$ C.