



# SBS7028 SERIES ~ Shielded SMD Power Inductors



RoHS Compliant

## PART NUMBERING SYSTEM

<b>SBS</b>	<b>7028</b>	—	<b>100M</b>	—	<b>LF</b>
TYPE	DIMENSIONS		INDUCTANCE		LEAD FREE

## SHAPES AND DIMENSIONS

UNIT : mm

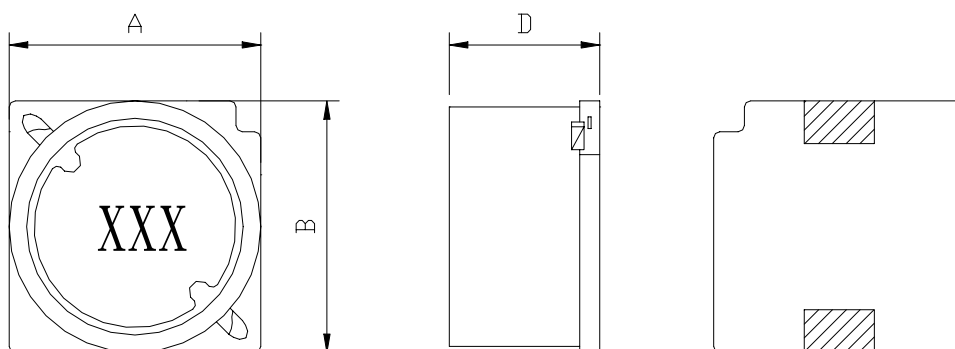

**A=7.2 Max. B=7.2 Max. D=3.0 Max.**

## RECOMMENDED PATTERNS

UNIT : mm

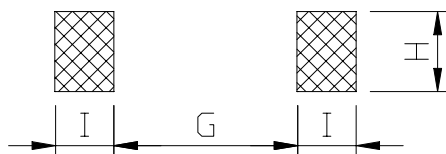

**G=4.9 H=2.2 I=1.5**

## FEATURES

- Magnetically shielded construction
- Suitable for large current
- Ideal for a variety of DC-DC converter inductor applications .
- RoHS compliant .



## SBS7028 SERIES ~ Shielded SMD Power Inductors



RoHS Compliant

### SPECIFICATION TABLE

PART NUMBER	INDUCTANCE ( $\mu$ H)	DCR ( $\Omega$ ) (max)	IDC (A) (max)	TEST FREQ. ( f )
SBS7028-3R3M-LF	3.3 $\pm$ 20%	0.0444	1.6	100KHz
SBS7028-4R7M-LF	4.7 $\pm$ 20%	0.0540	1.5	100KHz
SBS7028-6R8M-LF	6.8 $\pm$ 20%	0.0708	1.3	100KHz
SBS7028-100M-LF	10 $\pm$ 20%	0.0996	1.1	100KHz
SBS7028-150M-LF	15 $\pm$ 20%	0.156	0.88	100KHz
SBS7028-220M-LF	22 $\pm$ 20%	0.216	0.75	100KHz
SBS7028-330M-LF	33 $\pm$ 20%	0.288	0.65	100KHz
SBS7028-470M-LF	47 $\pm$ 20%	0.408	0.54	100KHz

- DC current at which the inductance drops 10% (typ) from its value without current.
- Operating temperature range -40 $^{\circ}$ C to +85 $^{\circ}$ C ,
- Electrical specifications at 25 $^{\circ}$ C .

### PACKAGING SPECIFICATION

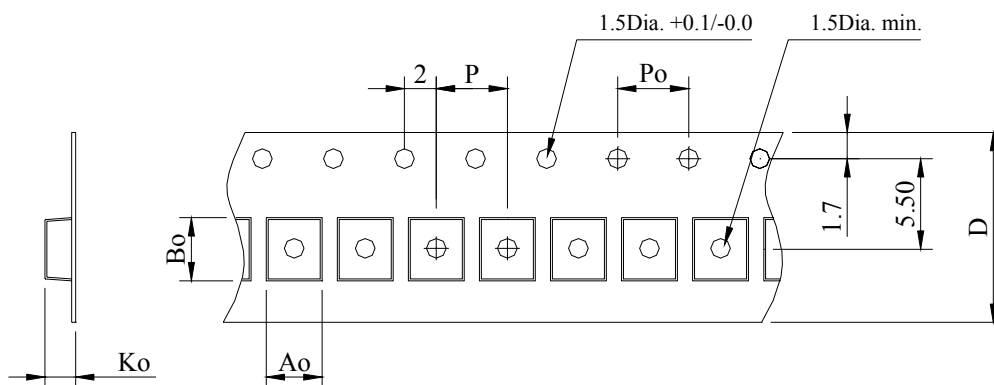

STAYLE	Q' TY (PCS)	DIMENSIONS (m/m)					
		Ao	Bo	Ko	P	Po	D $\pm$ 0.3
13"	1,000	7.50	7.50	3.50	8.00	4.00	12.0