



SDC3D14S SERIES

Low Profile Shielded Power Inductors



RoHS Compliant

PART NUMBERING SYSTEM

SDC	3D14S	—	1 R 0 N	—	LF
TYPE	DIMENSIONS		INDUCTANCE		LEAD FREE

SHAPES AND DIMENSIONS

UNIT : mm

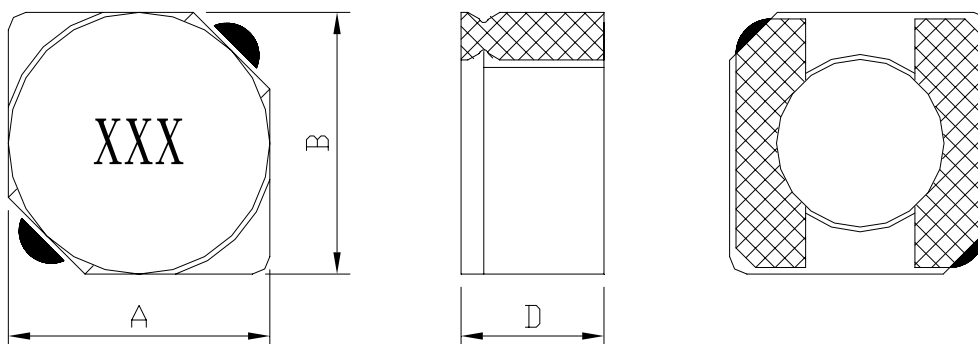

A=4.0 Max. B=4.0 Max. D=1.55 Max.

PCB LAYOUT

UNIT : mm

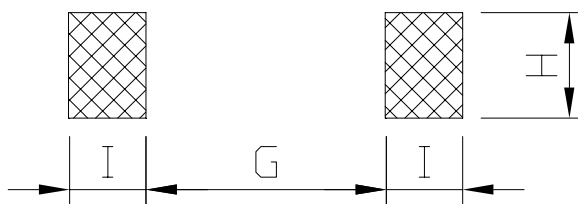

G=1.30 H=3.90 I=1.30

FEATURES

- Only **4.0 mm square** and **1.55 mm high**
- **Magnetically shielded, low profile** power inductor
- Saturation current rating **up to 2.55 Amps**
- Inductance ratings from 1.0 to 1,500 μ H
- **RoHS-compliant.** 260°C compatible. Gold over nickel over phos bronze terminations



SDC3D14S SERIES

Low Profile Shielded Power Inductors



RoHS Compliant

ELECTRICAL CHARACTERISTICS :

PART NUMBER	INDUCTANCE (μ H)	DCR (m Ω) (max)	Isat (A) (Max.)	Irms (A) (Max.)	TEST FREQ. (f)
SDC3D14S-1R0N-LF	1.0 \pm 30%	0.045	2.55	2.10	100KHz
SDC3D14S-2R2N-LF	2.2 \pm 30%	0.100	1.50	1.60	100KHz
SDC3D14S-3R3N-LF	3.3 \pm 30%	0.145	1.30	0.35	100KHz
SDC3D14S-4R7N-LF	4.7 \pm 30%	0.175	1.30	0.25	100KHz
SDC3D14S-4R7N-LF	5.6 \pm 30%	0.220	1.20	1.10	100KHz
SDC3D14S-6R8N-LF	6.8 \pm 30%	0.240	0.86	1.10	100KHz
SDC3D14S-8R2N-LF	8.2 \pm 30%	0.270	0.78	1.00	100KHz
SDC3D14S-100M-LF	10 \pm 20%	0.330	0.70	0.87	100KHz
SDC3D14S-150M-LF	15 \pm 20%	0.440	0.59	0.82	100KHz
SDC3D14S-180M-LF	18 \pm 20%	0.575	0.71	0.68	100KHz
SDC3D14S-220M-LF	22 \pm 20%	0.720	0.49	0.60	100KHz
SDC3D14S-330M-LF	33 \pm 20%	0.920	0.40	0.58	100KHz
SDC3D14S-470M-LF	47 \pm 20%	1.40	0.34	0.47	100KHz
SDC3D14S-560M-LF	56 \pm 20%	1.55	0.31	0.42	100KHz
SDC3D14S-680M-LF	68 \pm 20%	1.80	0.29	0.40	100KHz
SDC3D14S-820M-LF	82 \pm 20%	2.00	0.26	0.39	100KHz
SDC3D14S-101M-LF	100 \pm 20%	2.75	0.24	0.37	100KHz
SDC3D14S-121M-LF	120 \pm 20%	3.45	0.22	0.30	100KHz
SDC3D14S-151M-LF	150 \pm 20%	4.10	0.20	0.27	100KHz
SDC3D14S-181M-LF	180 \pm 20%	4.80	0.18	0.25	100KHz
SDC3D14S-221M-LF	220 \pm 20%	6.00	0.17	0.22	100KHz
SDC3D14S-331M-LF	330 \pm 20%	9.30	0.13	0.18	100KHz
SDC3D14S-471M-LF	470 \pm 20%	12.0	0.11	0.16	100KHz
SDC3D14S-561M-LF	560 \pm 20%	14.0	0.11	0.145	100KHz
SDC3D14S-681M-LF	680 \pm 20%	18.5	0.105	0.125	100KHz
SDC3D14S-821M-LF	820 \pm 20%	24.0	0.100	0.110	100KHz
SDC3D14S-102M-LF	1000 \pm 20%	31.0	0.100	0.100	100KHz
SDC3D14S-152M-LF	1500 \pm 20%	44.0	0.090	0.090	100KHz

- Isat : DC current at which the inductance drops 30% (typ) from its value without current.
- Irms: The actual current when temperature of coil becomes Δ 40°C . (Ta=+20°C)
- Operating temperature range -40°C to +85°C , Electrical specifications at 20°C.
- Packing : 13" reel, machine-ready ,embossed plastic tape (3,500 parts per full reel).