



**Coilmaster Electronics Co., Ltd.**

9F-3 No.398, Huan Bei Rd. Chung Li City, Taoyuan 320, Taiwan  
 Tel : +886-3-422-8279 Fax : +886-3-422-8734

E-mail : [info@coilmaster.com.tw](mailto:info@coilmaster.com.tw)

Web Site : [www.coilmaster.com.tw](http://www.coilmaster.com.tw)

## RCB1618 SERIES



RoHS Compliant

### PART NUMBERING SYSTEM

<u><b>RCB</b></u>	<u><b>1618P</b></u>	—	<u><b>100M</b></u>	—	<u><b>LF</b></u>
TYPE	DIMENSIONS		INDUCTANCE		LEAD FREE

**U** : UL Tube

**P** : PVC Tube

### SHAPES AND DIMENSIONS

UNIT : mm

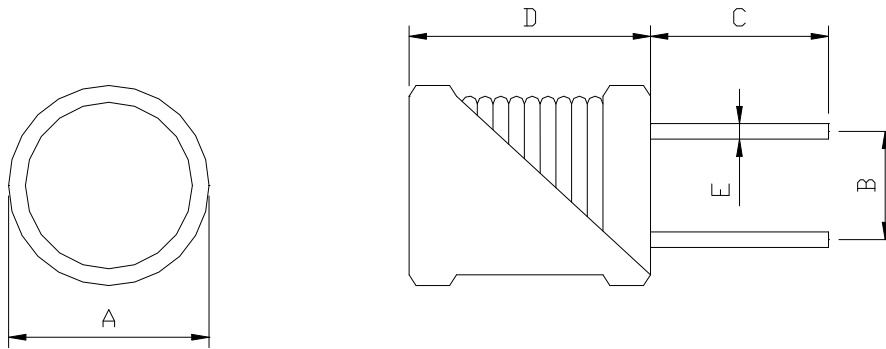

**A= 18.0 Max. , B= 10.0±0.5 , C= 15.0±5.0 , D= 20.0 Max. , E= 1.0 Ref.**

### STRUCTURAL DIAGRAM :

	COMPONENT	MATERIALS
	1.Core	Ferrite core
	2.Wire	Polyurethane enameled copper wires
	3.Lead wire	Tinned copper wires
	4.Tube	Heat shrinkable tube, PET or UL
	5.Glue	Epoxy resin

**Coilmaster Electronics Co., Ltd.**9F-3 No.398, Huan Bei Rd. Chung Li City, Taoyuan 320, Taiwan  
Tel : +886-3-422-8279 Fax : +886-3-422-8734E-mail : [info@coilmaster.com.tw](mailto:info@coilmaster.com.tw)  
Web Site : [www.coilmaster.com.tw](http://www.coilmaster.com.tw)**RCB1618 SERIES**

RoHS Compliant

**SPECIFICATION TABLE**

PART NUMBER	INDUCTANCE ( $\mu$ H)	DCR (m $\Omega$ ) (max)	IDC ( A ) (max)	TEST FREQ. ( f )
RCB1618-100M-LF	10	9	8.0	1KHz
RCB1618-250K-LF	25	22	6.0	1KHz
RCB1618-500K-LF	50	36	4.0	1KHz
RCB1618-101K-LF	100	90	3.0	1KHz
RCB1618-251K-LF	250	150	2.0	1KHz
RCB1618-501K-LF	500	300	1.2	1KHz
RCB1618-101K-LF	1000	600	1.0	1KHz

1. Inductors Tolerance : K = +/-10% ; M= +/-20%
2. Operating temperature range -40°C to +85°C
3. Electrical specifications at 25°C