



Flat Wire High Efficiency SMD Inductor SEP0603A



PART NUMBERING SYSTEM

SEP	0603A	—	1R8M	—	LF
TYPE	DIMENSIONS		INDUCTANCE		LEAD FREE

SHAPES AND DIMENSIONS :

UNIT : mm



FEATURES :

- * Low profile.
- * Magnetically shielded low DC resistance .
- * Suitable for large current application.
- * Prevent EMI effect via precise impedance
- * Laptop & Notebook computers.
- * Battery powered equipment.
- * DC/DC converters.
- * Digital 、Cameras 、Scanners, CD-ROM & DVD.

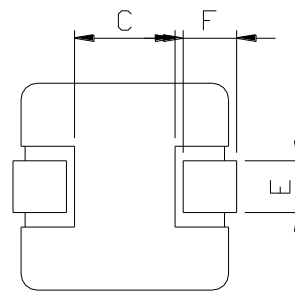
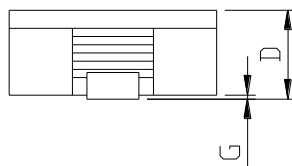
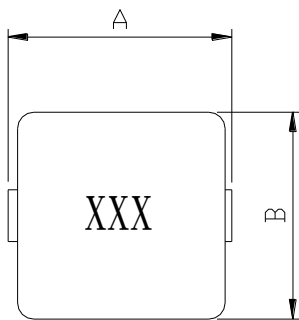

A=7.0±0.4 B=6.9±0.4 D=3.3 Max. E=1.2±0.5 F=1.8±1.0

UNIT : mm

RECOMMENDED PATTERNS

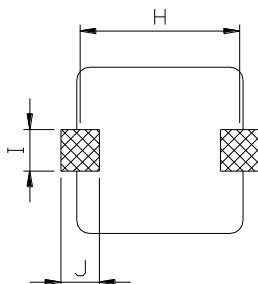

H=5.10

I= 2.20

J= 2.70

UNIT : mm



Flat Wire High Efficiency SMD Inductor SEP0603A

SPECIFICATION TABLE

PART NUMBER	INDUCTANCE (μH)	I _{sat} (A) (Typ.)	I _{rms} (A) (Δt) 40°C (Typ.)	DCR (mΩ) (Max.)	Test Freq. (KHz)
SEP0603A-R13N-LF	0.13±30%	48.0	22	1.00	100KHz/0.1V
SEP0603A-R24M-LF	0.24±20%	40.0	18	1.98	100KHz/0.1V
SEP0603A-R52M-LF	0.52±20%	20.0	14	4.07	100KHz/0.1V
SEP0603A-R95M-LF	0.95±20%	13.0	11	6.82	100KHz/0.1V
SEP0603A-1R2M-LF	1.15±20%	13.0	8.5	9.46	100KHz/0.1V
SEP0603A-1R5M-LF	1.5±20%	12.0	7.5	13.97	100KHz/0.1V
SEP0603A-2R0M-LF	2.0±20%	9.0	6.5	15.62	100KHz/0.1V

- I_{sat} : DC current at which the inductance drops 30% (typ) from its value without current.
- I_{rms} : Average current for a 40°C temperature rise above 25°C ambient.
- Operating temperature range -40°C to +125°C , Electrical specifications at 25°C.
- Custom design available.

PACKAGING SPECIFICATION

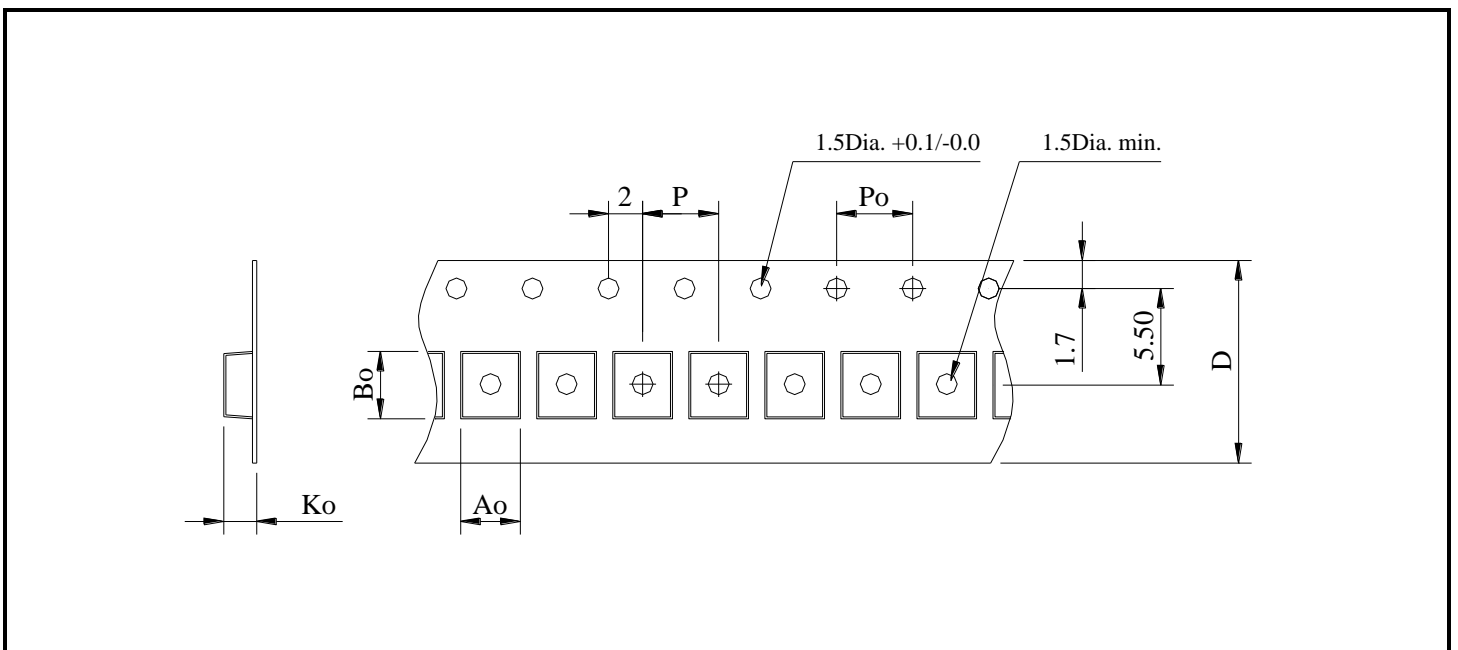

STAYLE	Q' TY (PCS)	DIMENSIONS (m/m)					
		Ao	B0	Ko	P	Po	D±0.3
13"	1,500	7.2	7.8	3.5	12	4.0	16