



Flat Wire High Efficiency SMD Inductor SEP0605A



PART NUMBERING SYSTEM

SEP	0605A	—	1R8M	—	LF
TYPE	DIMENSIONS		INDUCTANCE		LEAD FREE

SHAPES AND DIMENSIONS :

UNIT : mm



FEATURES :

- * Low profile.
- * Magnetically shielded low DC resistance .
- * Suitable for large current application.
- * Prevent EMI effect via precise impedance
- * Laptop & Notebook computers.
- * Battery powered equipment.
- * DC/DC converters.
- * Digital 、Cameras 、Scanners, CD-ROM & DVD.

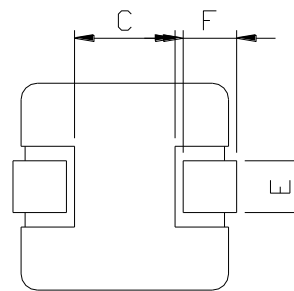
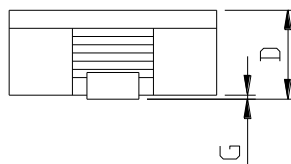
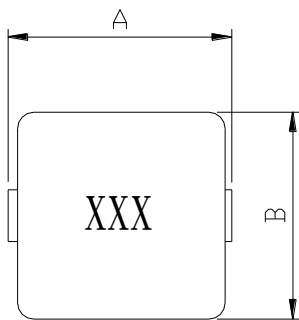

A=7.0±0.4 B=6.9±0.4 D=5.0 Max. E=1.2±0.5 F=1.8±1.0

UNIT : mm

RECOMMENDED PATTERNS

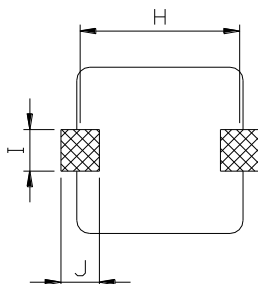

H=5.10 I= 2.20 J= 2.70

UNIT : mm



SPECIFICATION TABLE

PART NUMBER	INDUCTANCE (μH)	Isat (A) (Typ.)	Irms (A) (Δt) 40°C (Typ.)	DCR (mΩ) (Max.)	Test Freq. (KHz)
SEP0605A-R24N-LF	0.24±30%	28.0	20.0	1.1.0	100KHz/0.1V
SEP0605A-R47M-LF	0.47±20%	20.0	18.0	1.49	100KHz/0.1V
SEP0605A-R76M-LF	0.76±20%	15.0	15.5	2.48	100KHz/0.1V
SEP0605A-1R1M-LF	1.1±20%	13.0	15.0	3.47	100KHz/0.1V
SEP0605A-1R5M-LF	1.5±20%	11.0	13.0	4.73	100KHz/0.1V
SEP0605A-2R0M-LF	2.0±20%	9.0	11.5	6.44	100KHz/0.1V
SEP0605A-3R3M-LF	3.3±20%	8.0	9.0	9.9.0	100KHz/0.1V
SEP0605A-4R9M-LF	4.9±20%	6.5	6.5	15.95	100KHz/0.1V
SEP0605A-6R5M-LF	6.5±20%	6.0	6.0	23.65	100KHz/0.1V
SEP0605A-7R6M-LF	7.6±20%	4.8	4.2	33.22	100KHz/0.1V
SEP0605A-8R5M-LF	8.5±20%	4.5	4.0	35.75	100KHz/0.1V
SEP0605A-100M-LF	10±20%	4.0	3.5	36.3.0	100KHz/0.1V

- Isat : DC current at which the inductance drops 30% (typ) from its value without current.
- I rms : Average current for a 40°C temperature rise above 25°C ambient.
- Operating temperature range -40°C to +125°C , Electrical specifications at 25°C.
- Custom design available.

PACKAGING SPECIFICATION

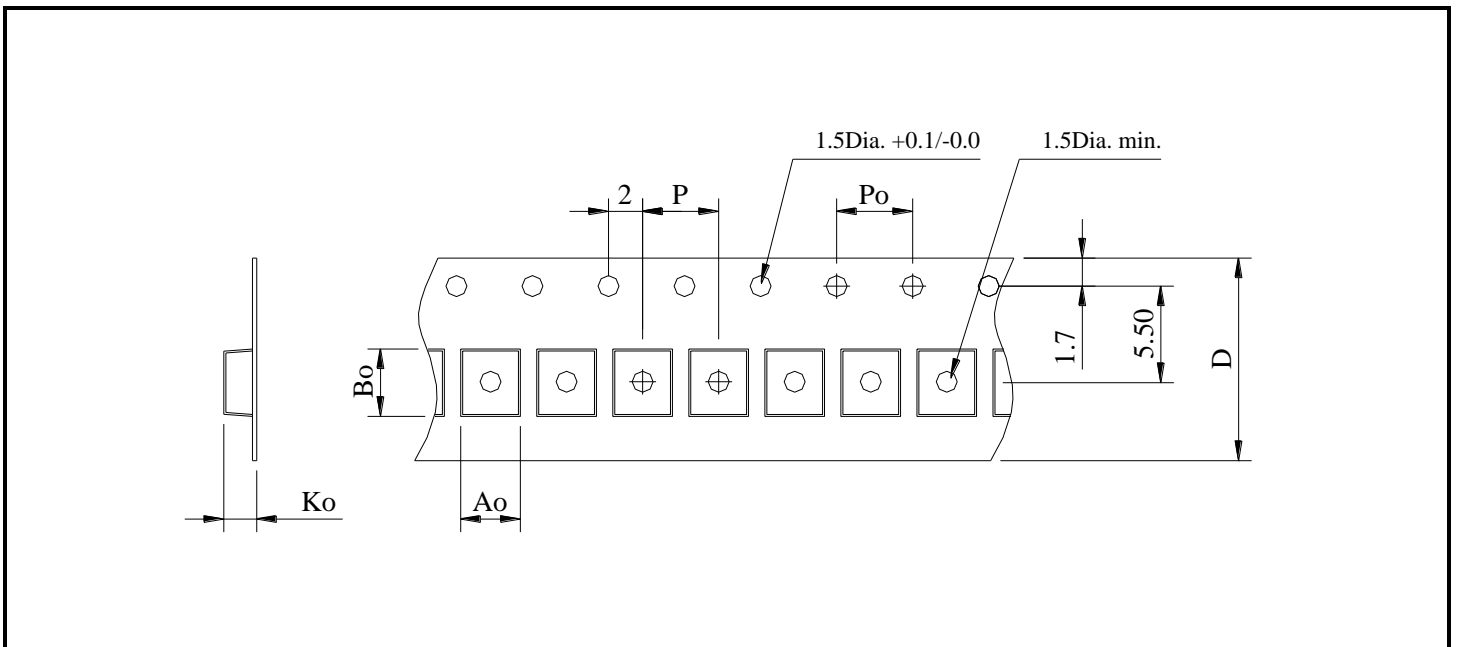

STAYLE	Q' TY (PCS)	DIMENSIONS (m/m)					
		Ao	Bo	Ko	P	Po	D±0.3
13"	1,000	7.2	7.8	5.2	12	4.0	16

Our specification limit the quality of the component to a single unit.
 Please ensure the component is thoroughly evaluated in your application circuit
 Revised Feb 2023